

**ROFROST TURBO from 2013**  
**No. 62200, 62203**

dated: 01/15

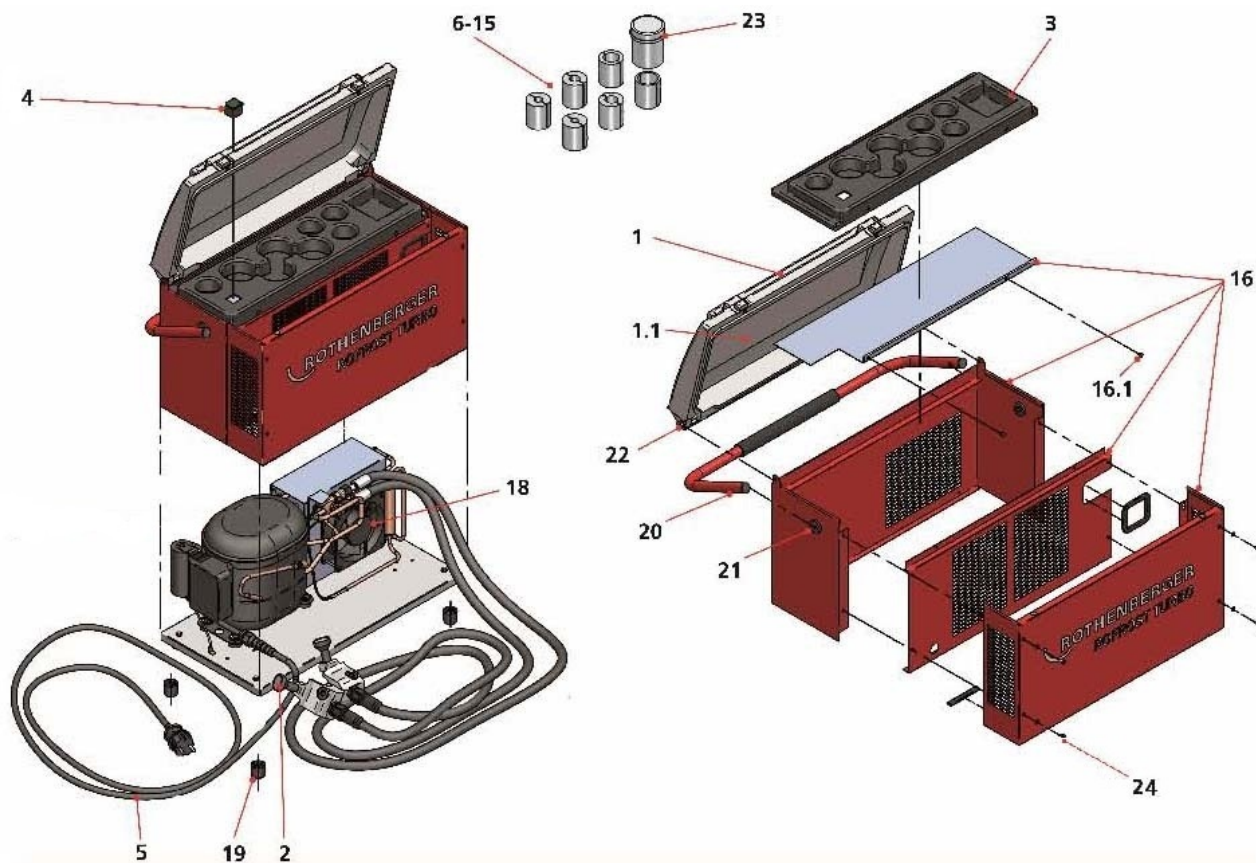

**ROFROST TURBO from 2013**  
**No. 62200, 62203**

dated: 01/15

Item no.	Description	Article no.	Quantity	Price (€)
1	Cover pre-assembled	F86653	1	o.r.
1.1	Sticker for cover	F91414	1	o.r.
2	Clamping screw with thermometer	F86660	2	o.r.
3	Insert for ROFROST new 1 1/4" and 2"	1500000984	1	o.r.
3	Insert for ROFROST old 2"	F86716	1	o.r.
3	Insert for ROFROST old 1 1/4"	F86603	1	o.r.
4	Switch with signal lamp	F86265	1	o.r.
5	Power Cord 230V	1500000816	1	o.r.
6 - 15	Reduction inserts 28mm (Gr. IX)	62215	1	o.r.
6 - 15	Reduction inserts 18mm / 3/8" (Gr. V)	62213	1	o.r.
6 - 15	Reduction inserts 35mm / 1.3/8" (Gr. XII)	62216	1	o.r.
6 - 15	Reduction inserts 12mm / 1/2" (Gr.II)	62211	1	o.r.
6 - 15	Reduction inserts 14/15mm /1/4" (Gr.III)	62212	1	o.r.
6 - 15	Reduction inserts 22mm / 7/8" (Gr.VII)	62214	1	o.r.
6 - 15	Reduction inserts 2" 1.1/2" (Gr.F)	62236	1	o.r.
6 - 15	Reduction inserts 2" 42mm /1.1/4" (Gr.E)	62235	1	o.r.
6 - 15	Reduction inserts 2" 35mm / 1.3/8" /1" (Gr.D)	62234	1	o.r.
6 - 15	Reduction inserts 2" 28mm / 3/4" (Gr.A)	62231	1	o.r.
16	Housing pre-assembly. ROFROST TURBO I+II	F86634	1	o.r.
16.1	Pin 4,4 x 4,5 - 5,5	1500000813	2	o.r.
18	Axial blower	F86628	1	o.r.
19	Repair set rubber foot	1500000812	4	o.r.
20	Grip pre-assembled	F86606	1	o.r.
21	Mounting set for grip	1500000814	1	o.r.
22	Mounting set for cover	1500000815	1	o.r.
23	Heat conductive paste, 150 ml	62291	1	o.r.
24	Screw M 4X8 mm DIN 7985	F86282	6	o.r.
24	Serrated washer A 4,3 mm DIN 6797	F86280	8	o.r.

**IMPORTANT!** To assure safety and reliability, repairs, maintenance and adjustment must be performed by ROTHENBERGER Kelkheim or authorized Service-Centers. Always use Original-Service-Parts. Order your accessories and spare parts from your specialist retailer or using our Service After Sales hotline